

# Connector

## installation guide

---

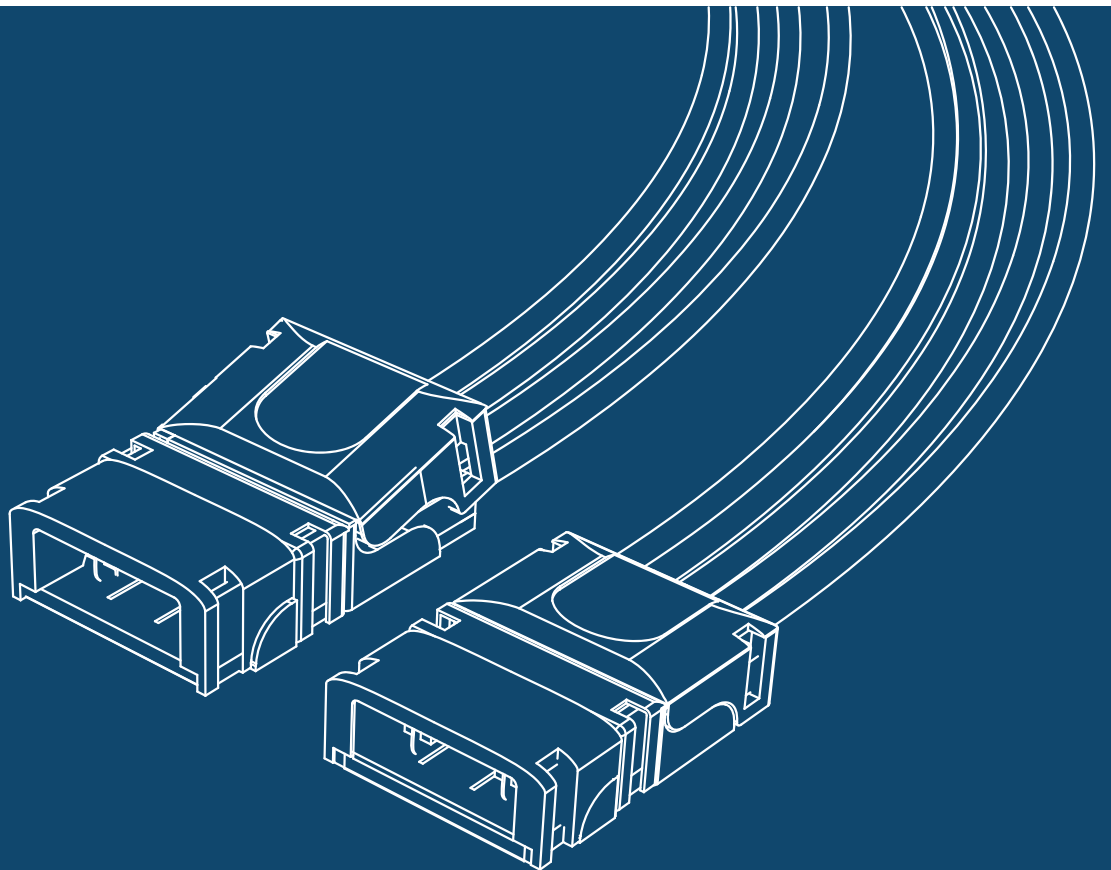

**FLEXFIRELEDs**

[www.flexfireleds.com](http://www.flexfireleds.com)

---

# Preparing LED Strips for Connection

## 01. Check your products

Make sure you have the correct products for your project and check them to see if there are any defects. You can first do a simple mock-installation by laying out the lights and connecting them to the appropriate power unit. Double check to see if the color temperature is correct and all of the LEDs are working properly.

**Remember: Test your setup everytime before installing a new section. Example: Install the first section, connect it to power to make sure it works, connect the second section, etc.**

## 02. Cut the strip to the desired length

The next step is to figure out how long or short you want the strip to be. Take careful measurements so you can make accurate cuts. Using scissors, cut the LED strip at the desired length along the indicated black cut mark between the copper solder pads. Make sure you cut between the solder pads and not the solder joints (look below). Do not cut anywhere else except on the cut marks.

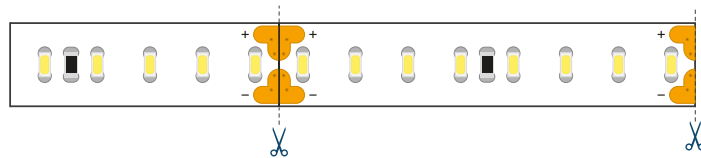

» When installing connectors with Architectural Dynamic Tunable White, Accent Dynamic Tunable White, Sienna Dim-to-Warm, or RGB 600 Series, you will need some more copper pad to work with.

You need to cut both solder pads so that the piece to be attached to the connector has more surface area to insert into the connector head.

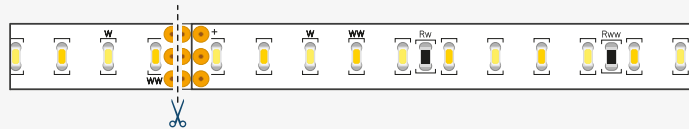

Special cases

» You cannot install the connector on the solder joints (pre-soldered points every 50 cm that attach the strips together during the manufacturing process).

Attach connector here

Do not attach connector here



## 03. Check the polarity before installation

Before installing the connectors, make sure the polarity of the strip matches the rest of your set-up. Follow the positive (+) markings from the power unit all the way through to the end of your run to match the corresponding (+) markings so you avoid having a segment of reversed polarity. The strip will not turn on if the positives (+) and negatives (-) are not matched.

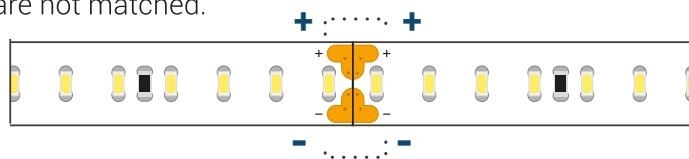

## 04. Remove part of the adhesive backing

Carefully peel off about a ¼" to ½" of adhesive tape from the back of the LED strip and push it back to make room for the connector. You can do this using a small blade or your nails.

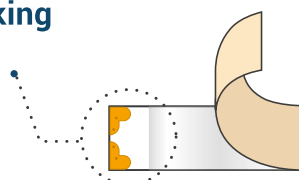

# Grip Connectors

## Installing Grip Connectors to LED Strip Lights

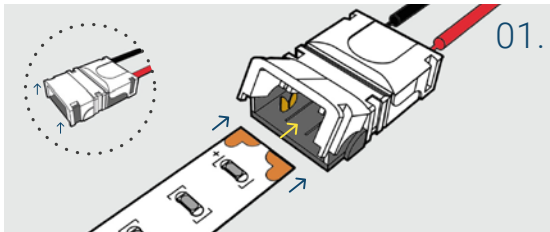

Open the top of the grip connector and insert the LED strip inside. Make sure the LED strip is facing up towards the translucent top and the solder pads are directly above the small hooks on the connector.

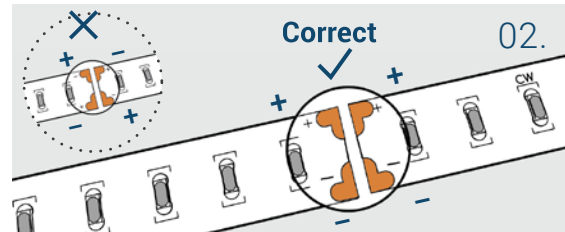

Double check the polarity of the strip to match the positive (+) markings together and negative (-) markings together. If you accidentally close the connector before you're ready, you can use a small flathead screwdriver to pry the top back open.

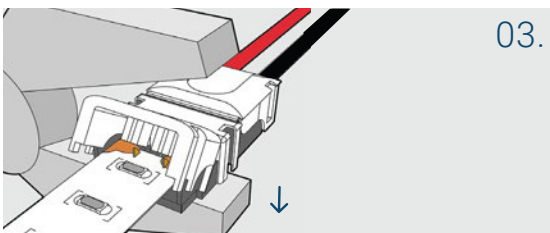

Once everything is in order, use pliers to close and lock the connector. You'll hear a "click" sound when it is properly closed.

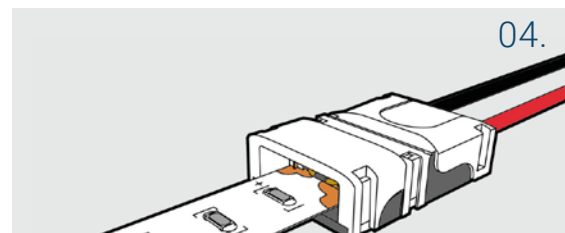

If you are using a jumper (strip-to-strip) connector, repeat steps 1 - 3 to the other side of the connector.

## Installing Grip Connectors to Wires

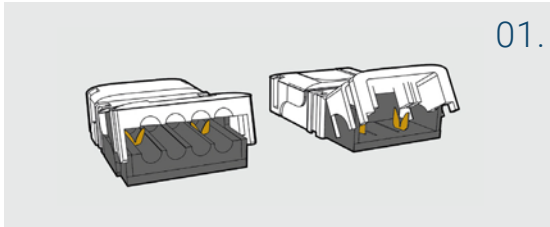

If you are using a grip connector with no attached wires, you need to open both ends to determine which side is for the strip and wire. The side with the flat surface is where the LED strip will be inserted, while the other has indentations on the bottom where the wires will sit.

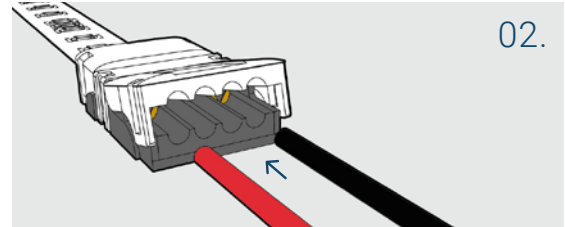

Use 20 or 22 AWG-sized stranded wires. You won't need to strip the wires before placing them in the connector because the connector will cut through the cover to make contact with the internal copper wire.

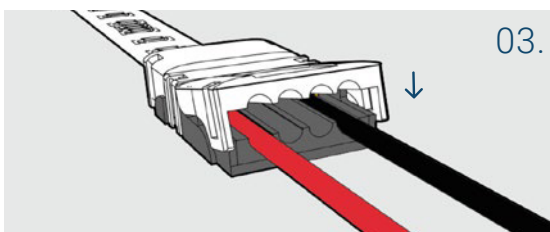

Fully insert the wires into the connector by placing them in their individual indent markings.

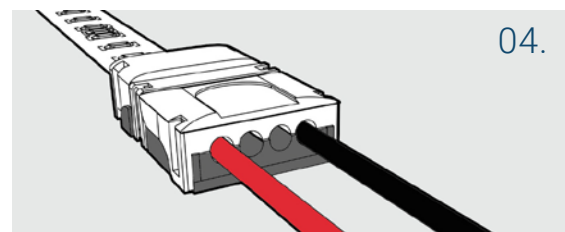

Test your LED strip by connecting it to your controller, dimmer, or power supply to turn on the lights.

**Note:** Make sure to connect the wires on both ends to the correct corresponding channel.

### Reference for Wire Placement:

- ColorBright™ Single Color (8mm strip width)-Two indents
- UltraBright™ Single Color (10mm strip width)-Four indents (NOTE: only use the two outside indents for wire placement)
- UltraBright™ Dynamic Tunable (10mm strip width)-Three indents
- ColorBright™ RGB (10mm strip width)-Four indents
- ColorBright™ RGB+W (12mm strip width)-Five indents

# If your lights are not turning on, double check to make sure...

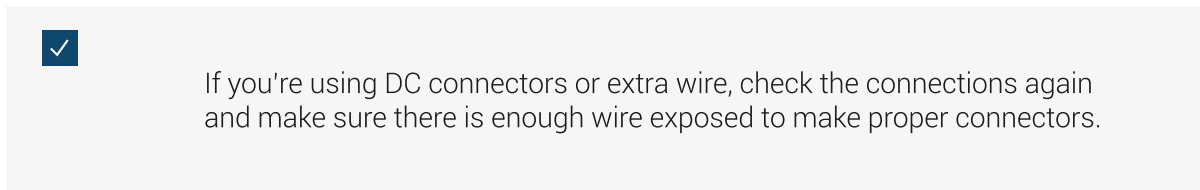
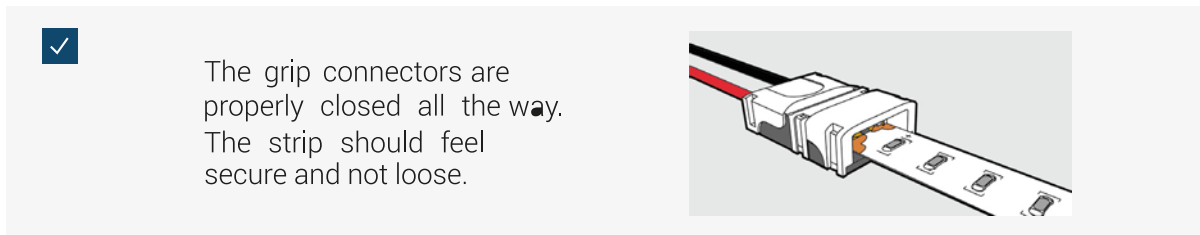
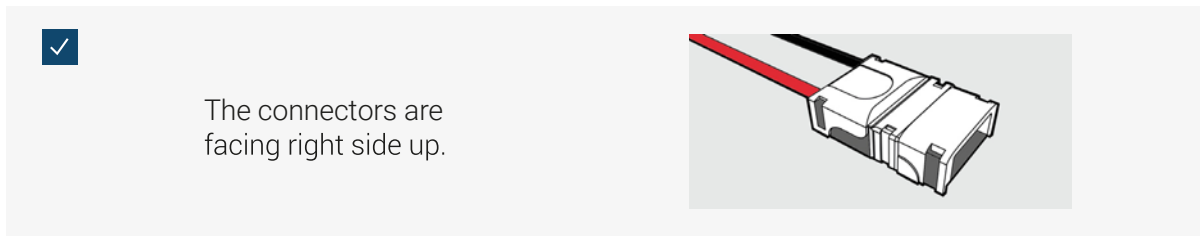
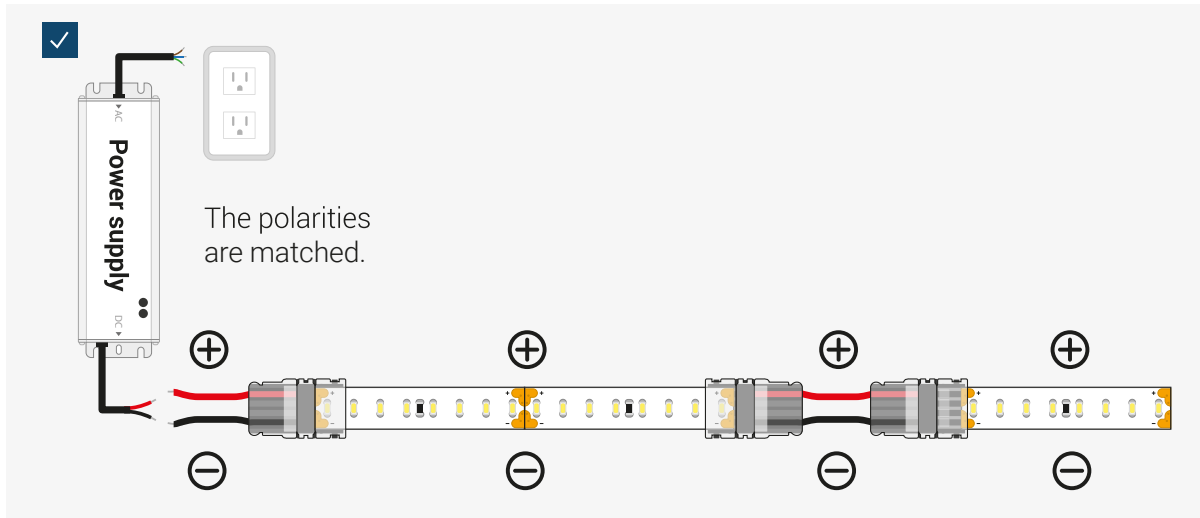

## Still having issues?

Contact our team of technicians at

 [support@flexfireleds.com](mailto:support@flexfireleds.com)

 Call (925) 273-9080 option 3 for after sales support

 **Toll Free Number:**  
1-844-353-934 7

 [info@FlexfireLEDs.com](mailto:info@FlexfireLEDs.com)

# Contact

information