



FLEXFIRELEDs

Victory™

LED Puck Lights

Product Data Sheet



 Please read all instructions carefully before installation.

Description

Victory™ LED Puck Lights are compact round fixtures that emit a single point of fully-dimmable bright light. They are perfect for applications requiring accent lighting or task lighting with great color rendering. They can be installed directly on a surface or recess mounted into cabinets or shelves and can be wired in series up to 7 pucks in a daisy chain run. The puck lights are low profile, lightweight, and have a 5-year warranty.



5-Year
Warranty



Product Features

Voltage	12V DC
Efficacy	Up to 65 lm/Wt
Brightness	Up to 260 lm
CRI	Up to 95
Beam Angle	120° Beam Angle
Ambient Temp	-4°F to 104°F (-20°C to 40°C)
Max Run Length in Series	Up to 7 fixtures
IP Rating	IP20 indoor/dry location use only
Fixture Color	Silver
Dimmable	Yes
Dimensions	2 ½" diameter (63 mm) x ½" height (12 mm)
Installation	Surface mount or recess mount

Product Specifications

Product SKU	Color CCT*	Watts / Fixture	Lumens / Fixture	Luminous Efficacy Lumens/Watt	CRI	Gamut Score (Rg)	Relative Fidelity Score (Rf)	TLCI
VIC-R-30K-S-12V	3000K	3.2W	240 lm	60 lm/W	95	103	93	93
VIC-R-40K-S-12V	4000K	3.2W	260 lm	65 lm/W	92	97	90	91

*CCT may be +/-100K but always ordered from same bin and will present no noticeable differences perceived by the human eye.

Ordering Code

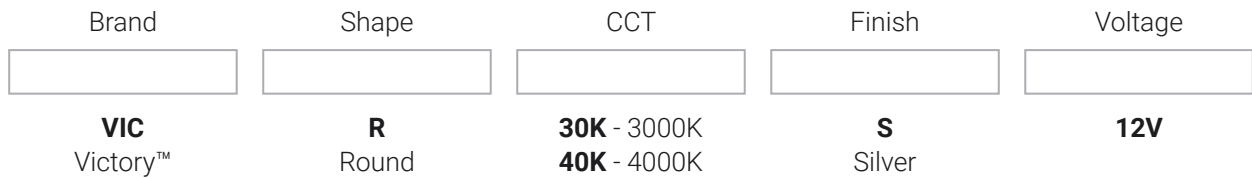

Dimensions

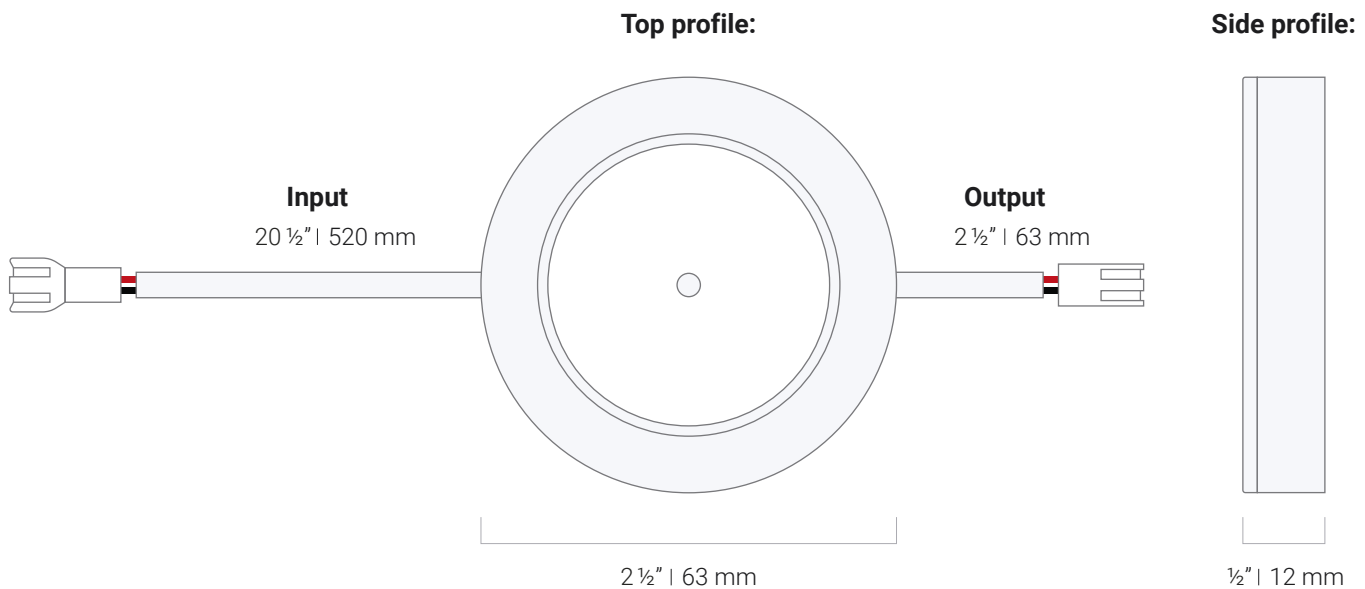

Controller Options



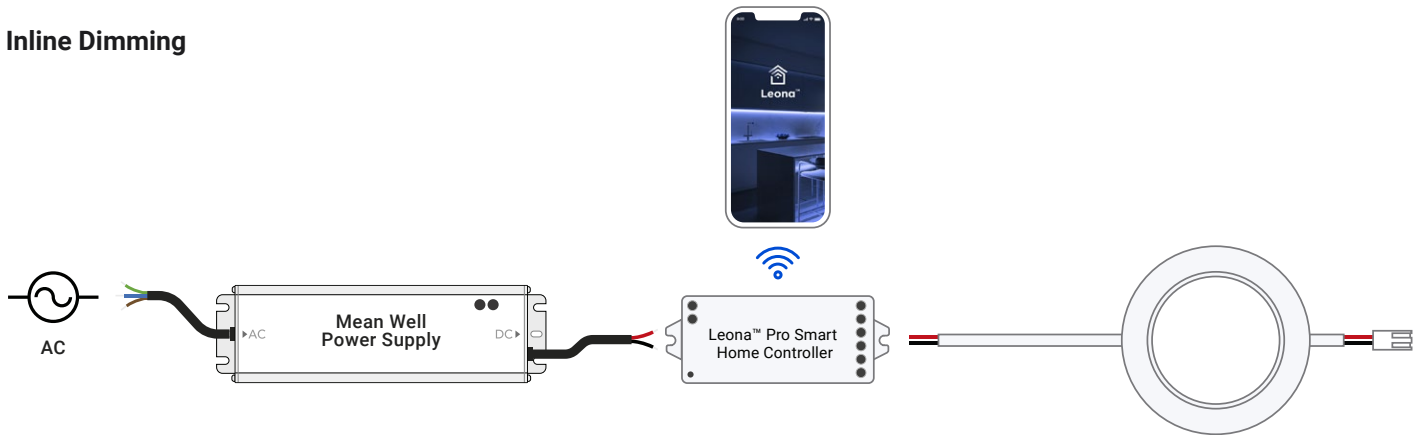

Inline Dimming

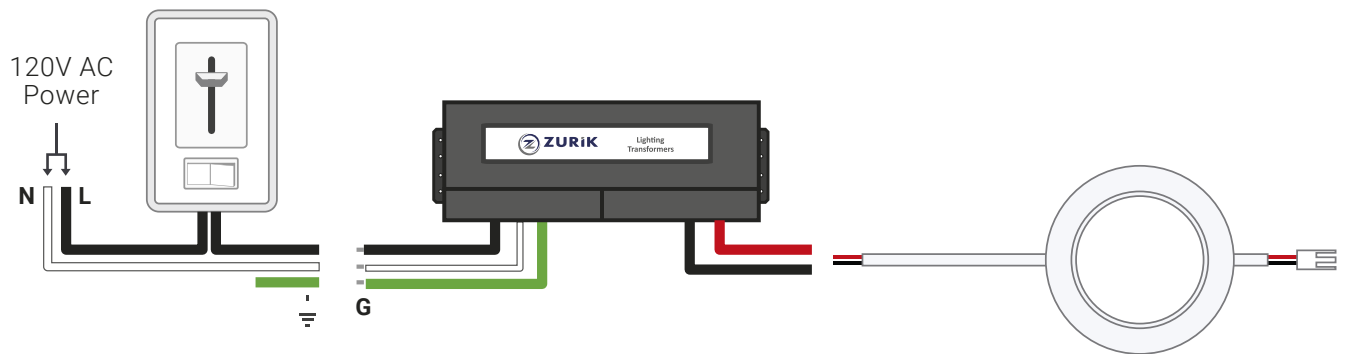





Lutron Style Wall Dimmer

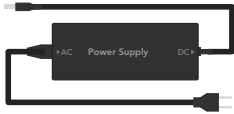

Accessories (Sold Separately)

Product SKU	Description	Image	Product SKU	Description	Image
VIC-DC-12IN	Victory™ LED DC Connector Cable - 1FT		VIC-C1-24IN	Victory™ LED Puck Light Extension Cable - 2FT	
VIC-4-WAY	Victory™ LED Puck Light 4-Way Splitter		VIC-C1-60IN	Victory™ LED Puck Light Extension Cable - 5FT	

Compatible Drivers

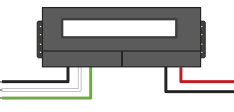
	Power Supply	Number of Fixtures	Product SKU	Diagram
Non-dimmable	Plug-In Power Supply	1 - 2	12V-WMPS2-1	
		3 - 5	12V-DPS2-2	
		6 - 11	12V-DPS2-4	
		12 - 17	12V-DPS2-6	
		18 - 23	12V-DPS2-8	
	Mean Well™ HLG	1 - 10	HLG-40H-12A	
		12 - 16	IHLG-80H-12A	
		17 - 32	HLG-120H-12A	
	Mean Well™ LPV	1 - 5	LPV-20-12	
		6 - 9	LPV-35-12	
10 - 15		LPV-60-12		
16 - 25		LPV-100-12		
Dimmable	Zurik® EMLV	1 - 8	ZRK-EMLV2-30W-12VDC	
		9 - 16	ZRK-EMLV2-60W-12VDC	
		17 - 32	ZRK-EMLV2-120W-12VDC-J	
	Zurik® Universal	1 - 8	ZRK-UNV-30W-12VDC	
		9 - 16	ZRK-UNV-60W-12VDC	
		17 - 32	ZRK-UNV-120W-12VDC	
		6 - 48 (Up to 16 pucks/output)	ZRK-UNV-C180W-12VDC	

Installation Instructions

Surface Mount Installation:

1. Turn power off at circuit breaker.

CAUTION: Risk of electric shock.

When working with electricity, turn the power off at the circuit breaker to avoid any possible injury before installing the puck lights.

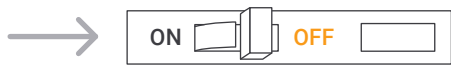

2. Detach mounting ring.

Separate the mounting ring from the puck light.

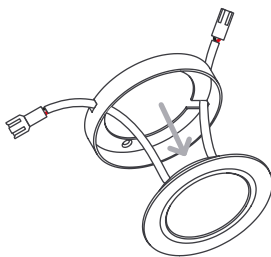

3. Route the cords.

Route the cords through the mounting ring. If the output daisy chain connector is not needed, wrap it around the puck before mounting.

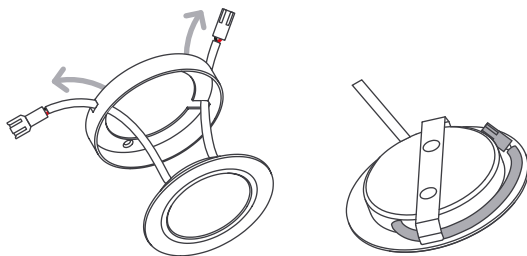

4. Secure the mounting ring.

Mount the ring to the surface with screws (included) and a Phillips head screwdriver (not included).

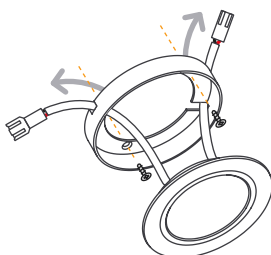

5. Attach the puck.

Gently pull the excess cord and push the puck back into the mounting ring.

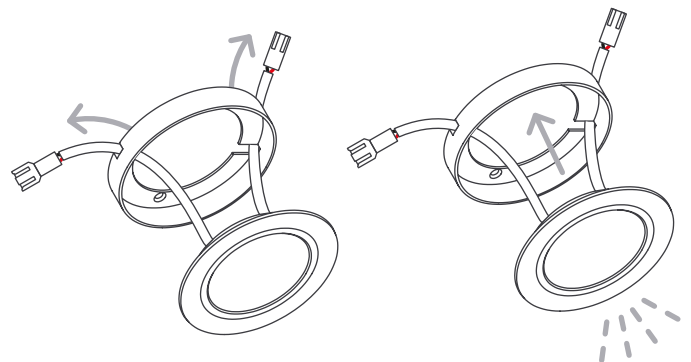

6. Connect to power.

Connect the puck light to the LED driver and lighting control (optional). If you are going to use our plug-in power supply, connect a DC Connector Cable (sold separately) to the puck light, and then connect to the driver. For hardwired installations, simply cut off the puck light's connector to expose the wires and attach it to the DC side of the LED driver.

Connection using plug-in power supply:

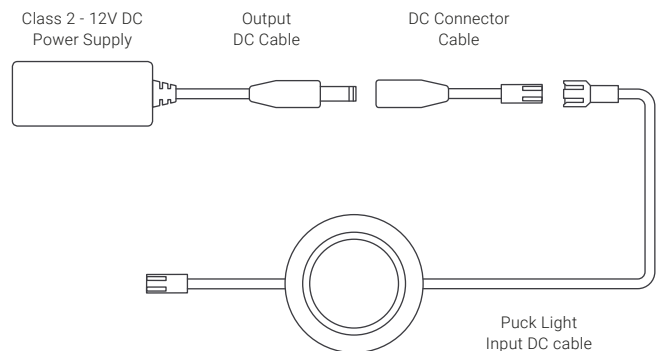

7. Turn power back on at circuit breaker.



Installation Instructions

Recessed Mount Installation:

1. Follow steps 1 and 2 of the Surface Mount Installation.

For recessed mounted installations, remove the mounting ring completely before the installation as you won't need it.

2. Prepare the surface.

Measure and mark the surface where you want to install the puck light. Then, drill a 2 ¼ inch hole through the cabinet or the shelf with a hole saw and drill.

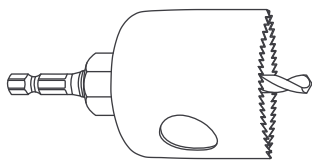

3. Route the cords.

Route the cords through the pre-drilled holes.

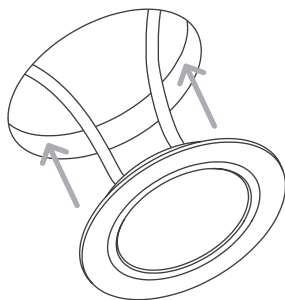

4. Install the puck.

Insert the puck into the hole and push firmly to secure it into place.

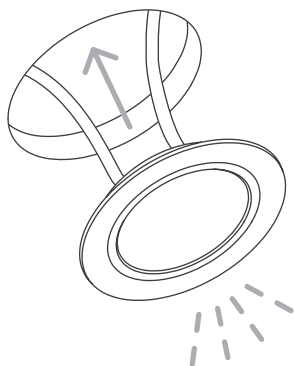

5. Follow step 6 and 7 of the Surface Mount Installation.



Safety And Disclosures

1. Installation must be in accordance with the National Electric Code (NEC) and local regulations.
2. To ensure safety and correct installation, this product is intended to be installed by a qualified, licensed electrician.
3. Install with a compatible Class 2 12VDC Constant Voltage LED driver.
4. Do not install in wet or outdoor locations or in environments where excessive heating may exist.
5. Do not bend, step on, or subject pressure or flexing. Do not cover the light or allow the light to be in contact with material that could pose a fire hazard.
6. Do not connect additional fixtures beyond the recommended number. Each maximum run requires a dedicated power feed from the LED driver.
7. Attached wire leads, connectors and accessories are not rated for in-wall installation.
8. Use a soft, dry cloth for cleaning.
9. Do not modify the product beyond instructions or warranty will be void.
10. We reserve the right to modify and improve the design of our fixtures without prior notice. Although we try our best to order the same colors every time, due to changes in technology and phosphors over time, we cannot guarantee to match existing installed fixtures for subsequent orders or replacements in regards to product appearance, CCT, or lumen output.

Warranty Information

Limited Warranty

This product has a 5-year limited warranty from the date of shipment. This warranty only includes the main product outlined in this specification sheet and does not include the additional accessories that are used as a reference. Complete warranty details for fixtures and additional accessories are available at <https://www.flexfireleds.com/warranties/> within the Policies section. For warranty related questions please contact the product support team at (support@flexfireleds.com).

Consumer's Acknowledgment

Flexfire LEDs, Inc. stands behind its products when they are used properly and according to our specifications. When you purchase our products, you are agreeing to the terms and conditions outlined in our warranty section. We try our best to make recommendations, but the burden of proper installation, design, and maintenance relies on the purchaser. This limited warranty does not include product failures that are the result of: Not using a voltage regulated power supply to connect the LED product or controls; Connecting LED products to the wrong output voltage; Improper connection of power supplies, LED products, or controls; Connecting LED products or controls directly to any AC power source if they are stated for DC only input; Connecting power supplies backwards to an AC power source; Products used in an inappropriate location or in environmental conditions (temperature, humidity, moisture, etc.) outside the normal specified range; Water damage to products not specifically sold as waterproof products; Electrical power surges and spikes; Damage from hail, flooding, tornado, fire, wind, earthquake, lightning, electrical storm, or any other natural disasters or "force majeure" incidences; Damage caused by a vehicle or other accident; Damage caused when transporting the item; Damage to any products that were modified by the user, used for purposes other than as intended or directed, or connected to LED systems or components not purchased from Flexfire LEDs; Products that have been subjected to misuse, mishandling, misapplication or accident. Products used in connection with any components, devices or systems other than those explicitly approved as compatible with Company's products and listed on Company's website. Excessive wear and tear and/or physical or accidental abuse, loss, or theft. Improper repairs or warranty services performed by someone other than Flexfire LEDs will void this warranty.



FLEXFIRELEDs

Contact Information



Toll Free Number:

1-844-353-9347



Local Number:

(925) 273-9080



info@flexfireleds.com

www.flexfireleds.com